

THIRD FLOOR KEY PLAN

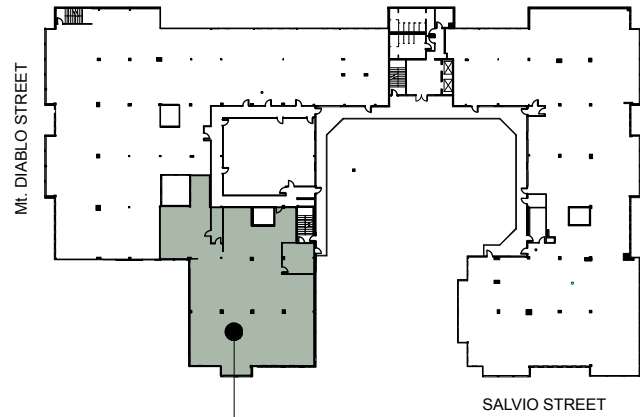

SUITE FLOOR LOCATION

SUITE 350
 APPROX.
 6,527 RSF*



Colliers International
 1850 Mount Diablo Boulevard, Suite 200
 Walnut Creek, CA 94596 | United States
 www.colliers.com

LEASING AGENT

Matt Hurd
 (925) 279-5567

matt.hurd@colliers.com

Scott Ellis
 (925) 279-5575

scott.ellis@colliers.com

**Salvio
 Pacheco
 Square**

2151 Salvio Street
 Concord, CA 94520

Third Floor

Owned & Managed by:

LeFever Mattson

Approximate Area Calculations
 Subject To Verification:

6,527rsf

Concept Plan To Be Verified

This information displayed while not guaranteed has been secured by sources we believe to be reliable. This information is subject to errors & omissions. Any tenant should conduct their own investigation.