

FOR SUBLEASE

3525 Arden Road, Suite 300

HAYWARD, CA



Property Features

- > ±66,048 square feet
- > ±9,000 square feet of office area
- > 28' clear height
- > Sprinkler density: 0.6/3,000
- > Column spacing: 48'x56'
- > Up to nineteen (19) dock high doors:
 - > Eleven (11) existing
 - > Eight (8) with pit levelers and curtains
 - > Eight (8) knock out panels
- > Up to three (3) grade level doors
 - > One (1) existing
 - > Two (2) knock out panels
- > Heavy power 1,500 Amps @ 480V (please verify)
- > Insulated warehouse
- > T5 lighting
- > Potential yard area of ±30,000 square feet
- > Immediate access to Highway 92 and I-880
- > Available immediately
Sublease through 9/30/15
Fixed option through 9/30/20

Sublease Rate: \$0.45 psf Gross!



The information furnished has been obtained from sources we deem reliable and is submitted subject to errors, omissions and changes. Although Colliers International has no reason to doubt its accuracy, we do not guarantee it. All information should be verified by the recipient prior to lease, purchase, exchange, or execution of legal documents. © 2012 Colliers International

GREIG LAGOMARSINO, SIOR
+1 510 433 5809
greig.lago@colliers.com
CA License No. 01063817

JOE YAMIN
+1 510 433 5812
joe.yamin@colliers.com
CA License No. 01327666

RICK KEELY
+1 510 433 5806
richard.keely@colliers.com
CA License No. 01130139

COLLIERS INTERNATIONAL
1999 Harrison Street, Suite 1750
Oakland, CA 94612
www.colliers.com

FOR SUBLEASE

3525 Arden Road, Suite 300



HAYWARD, CA

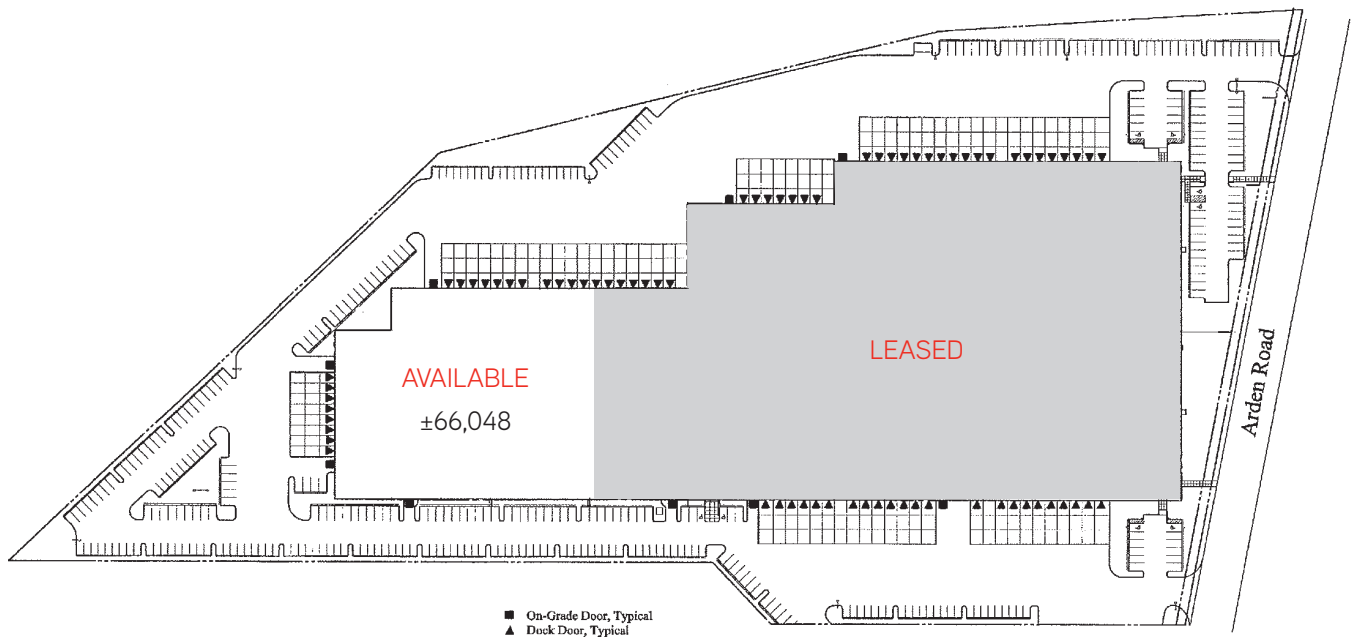

Contact Us

GREIG LAGOMARSINO, SIOR
+1 510 433 5809
greig.lago@colliers.com
CA License No. 01063817

JOE YAMIN
+1 510 433 5812
joe.yamin@colliers.com
CA License No. 01327666

RICK KEELY
+1 510 433 5806
richard.keely@colliers.com
CA License No. 01130139

FOR SUBLEASE

3525 Arden Road, Suite 300

HAYWARD, CA

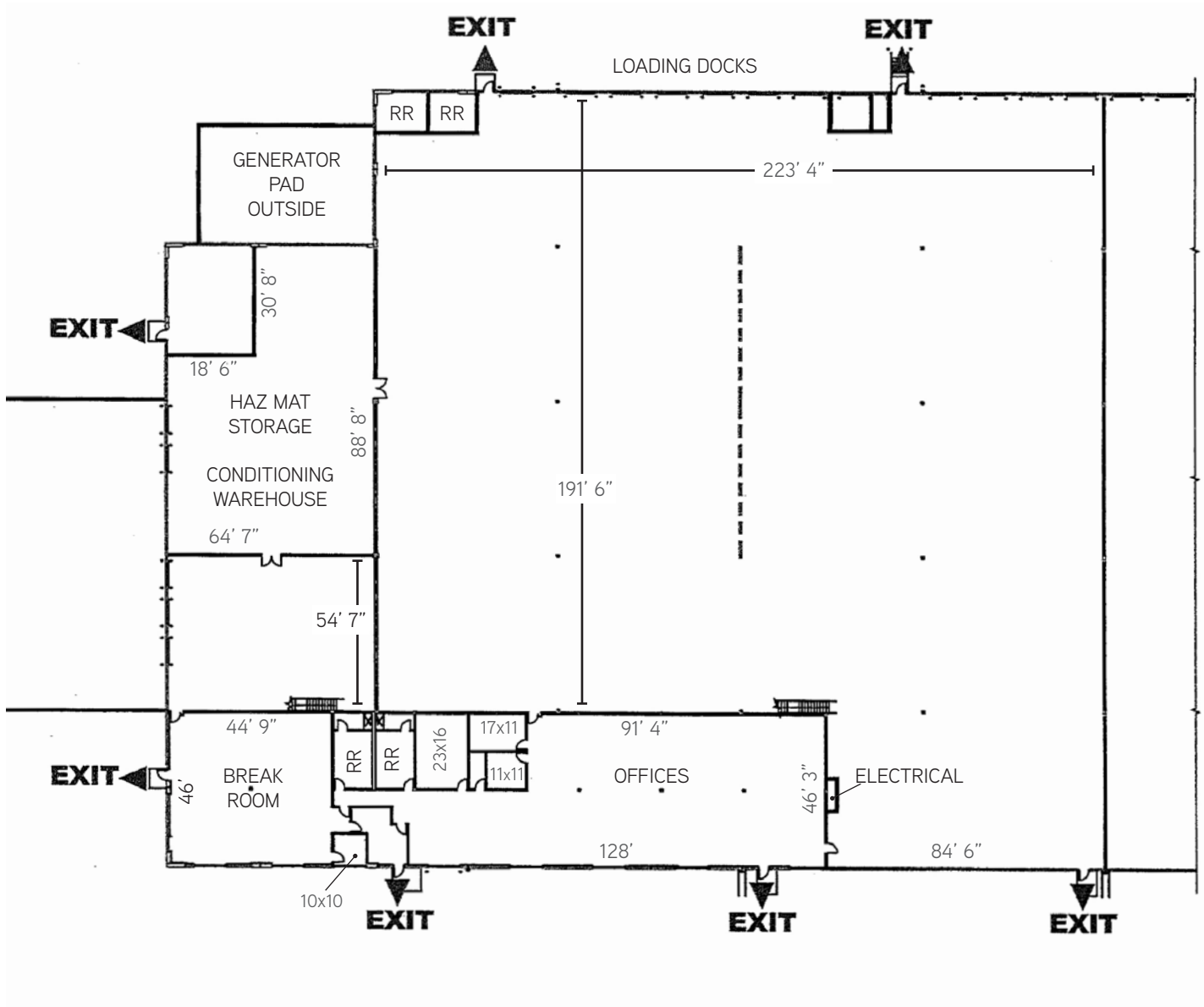

* All measurements are approximate.
Not to scale.