

FOR LEASE > ±2,800 SF OF WAREHOUSE WITH OFFICE

4680 East 2nd Street, Suite D

BENICIA, CA



Property Details

- > ±2,548 sq. ft. of Warehouse and ±252 sq. ft. of Office
- > ±16' - ±18' clear height
- > One (1) grade level door (±12' x ±14')
- > Sprinklered
- > Parking: 2/1,000
- > One (1) bathroom
- > Glass line store front
- > Great access to I-680

Lease Rate

- > \$0.85 per sq. ft., Gross



Contact Us

ERIC DAKIN
+1 707 863 8364
eric.dakin@colliers.com
CA License No. 01816124

TONY BINSWANGER
+1 707 863 8369
tony.binswanger@colliers.com
CA License No. 01861701

The information furnished has been obtained from sources we deem reliable and is submitted subject to errors, omissions, and changes. Although Colliers Parrish International, Inc. has no reason to doubt its accuracy, we do not guarantee it. All information should be verified by the recipient prior to lease, purchase, exchange, or execution of legal documents. © 2010 Colliers International

FOR LEASE > ±2,800 SF OF WAREHOUSE WITH OFFICE

4680 East 2nd Street, Suite D

BENICIA, CA

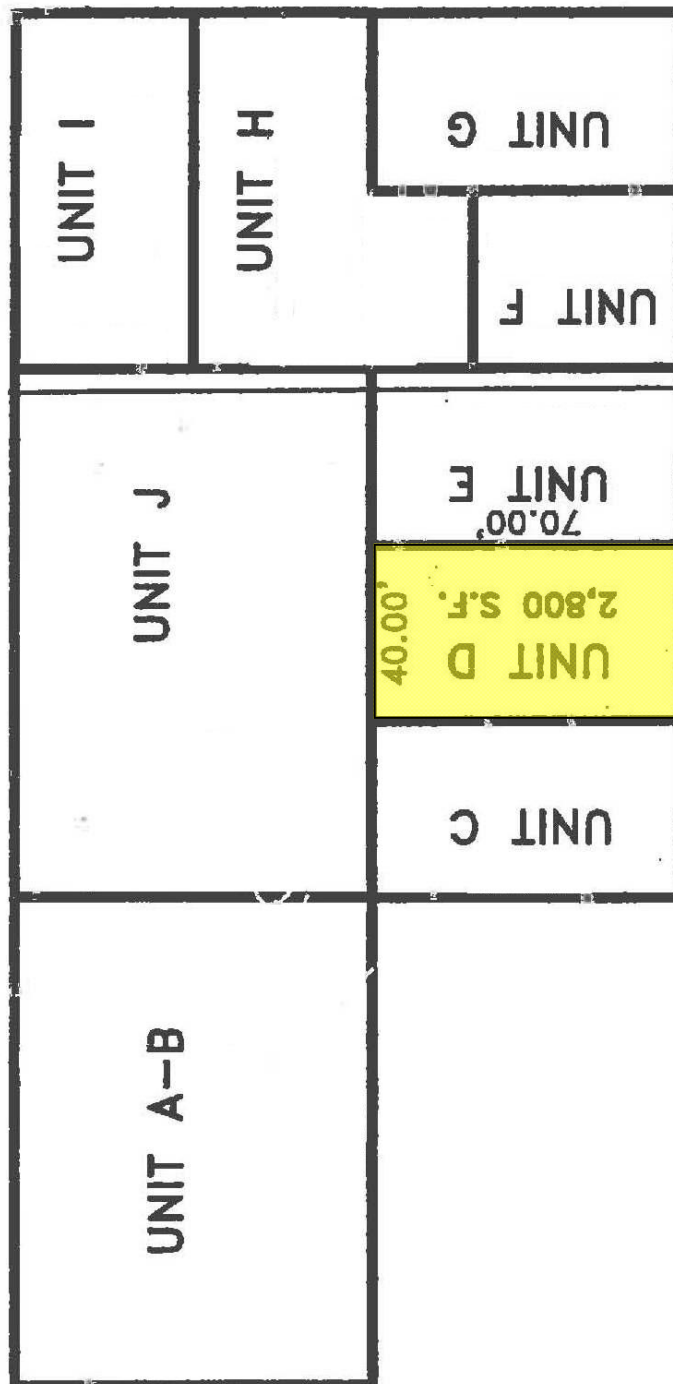

Contact Us

ERIC DAKIN
+1 707 863 8364
eric.dakin@colliers.com
CA License No. 01816124

TONY BINSWANGER
+1 707 863 8369
tony.binswanger@colliers.com
CA License No. 01861701

COLLIERS INTERNATIONAL
360 Campus Lane, suite 101
Fairfield, CA 94534
www.colliers.com